

For safety reasons our bins are supplied in-line with RAWLBOLT manufacturer guidelines with M13* holes for M10 bolt (bolt installed separately from anchor) with clearance for liner access.
Please specify if you require alternative installation setup.

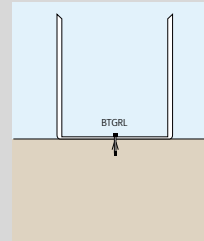

RAWL Bolts
BTGRRL25* | £17.99

Set of 4 bolts for ground fixing with a pre-drilled base. The ground is drilled in the same arrangement as the fixing holes in the base of the bin. Bolts are placed in position and tightened to secure in the ground.

Size	Product Code	Approval type	Anchor			Fixture	
			Diameter	External diameter	Length	Max. thickness	Hole diameter
			d	d _{nom}	L	t _{fix}	d _i
		-	[mm]	[mm]	[mm]	[mm]	[mm]
M10	R-RBL-M10/10W	ETA-11/0479	10	16	75	10	11
	R-RBL-M10/25W *	ETA-11/0479	10	16	90	25	11
	R-RBL-M10/50W	ETA-11/0479	10	16	115	50	11
	R-RBL-M10/75W	ETA-11/0479	10	16	140	75	11

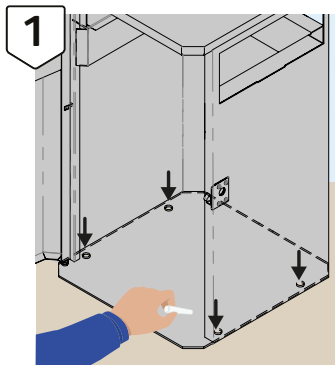

1 Position the bin with the door facing in the correct direction on flat ground without obstruction.

Use chalk to mark through the fixing holes onto the ground below.

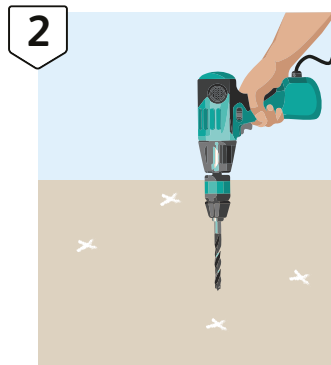

2 Remove the bin and mark the ground with a cross where the four hole positions are.

Drill 16mm holes in the 4 marked positions to a depth of 100mm or long enough to accommodate the bolt length.

Remove any debris from the holes.

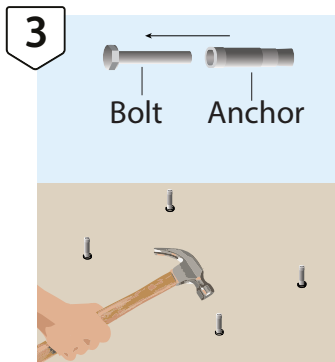

3 Remove bolt from Anchor.

Fit Anchors into the holes and use a hammer to drive the anchors in.

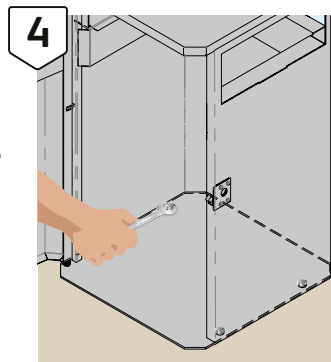

4 Use a spanner or socket to tighten the bolts and their washers. Tightening the bolts will fan out the bolt sheath in the hole holding the bolt secure. Replace the liner and shut the door.

(additional 3mm clearance provided for margin of error)